

ITEM	QTY.	DESCRIPTION
1	1	MOTOR - 1750 RPM, INDUSTRIAL DUTY, HP PER ORDER, PAINTED FINISH
2	1	GEARBOX - 350 RPM, 5:1 REDUCTION, SYNTHETIC LUBE, PAINTED FINISH
3	1	BEARING HOUSING - ALUMINUM, WITH HOLLOW BORE COUPLING, PAINTED FINISH
4	1	STAINLESS CLAMP MOUNT - BALL AND SOCKET TYPE
5	1	SHAFT - 316 STAINLESS STEEL SHAFT PER ORDER
6	1+	IMPELLER - 316 STAINLESS STEEL HYDROFOIL IMPELLER, SIZE AND QTY PER ORDER

#### STANDARD FEATURES

- CAST ALUMINUM HOUSING
- DUAL OVERSIZE ABEC-RATED BEARINGS
- STAINLESS CLAMP
- STAINLESS HOLLOW BORE COUPLING
- STAINLESS HARDWARE

#### AVAILABLE UPGRADES

- 32Ra SANITARY FINISH ON WETTED PARTS
- FILTER, LUBRICATOR REGULATOR (FLR) FOR AIR MOTORS
- EXPLOSION PROOF MOTOR FOR ELECTRIC MODELS

#### CLAMP MOUNT DETAIL

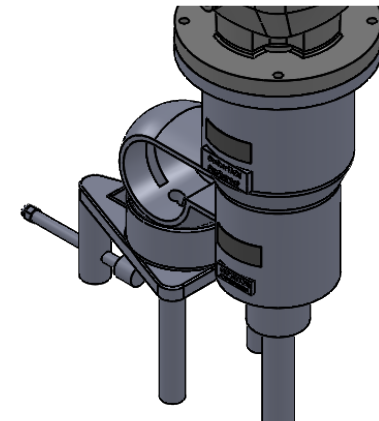

#### AIR CONSUMPTION FOR AIR MOTORS

1 HP	40 CFM @ 80 PSI
2 HP	60 CFM @ 70 PSI
3 HP	90 CFM @ 70 PSI

NOTE: ALL STAINLESS VERSION IS AVAILABLE  
 STAINLESS STEEL VERSION INCLUDES: STAINLESS MOTOR, STAINLESS GEARBOX, STAINLESS HARDWARE, STAINLESS BEARING HOUSING (WITH VITON O-RING UPPER SEAL AND VITON LIP SEAL LOWER SEAL)

DRAWN	NAME	DATE
CHECKED	SB	6/06/22
	DP	6/10/22

**FusionExpress**  
 FUSION FLUID EQUIPMENT LLC

THE INFORMATION CONTAINED IN THIS DRAWING IS THE SOLE PROPERTY OF FUSION FLUID EQUIPMENT LLC. ANY REPRODUCTION IN PART OR AS A WHOLE WITHOUT THE WRITTEN PERMISSION OF FUSION FLUID EQUIPMENT LLC IS PROHIBITED.

WHILE FUSION FLUID EQUIPMENT LLC STRIVES TO MAINTAIN THE INTEGRITY OF A DESIGN AS APPROVED, FUSION FLUID EQUIPMENT LLC RETAINS THE RIGHT TO MAKE MODIFICATIONS DURING THE MANUFACTURING PROCESS TO IMPROVE FIT, FORM, AND FUNCTION OF THE DESIGN WITHOUT CUSTOMER NOTIFICATION OR CONSENT.

UNLESS OTHERWISE SPECIFIED:  
 DIMENSIONS ARE IN INCHES.  
 NO TOLERANCE IS IMPLIED.  
 DO NOT SCALE DRAWING

TITLE: FUSION PRO PG-C GEAR DRIVE - CLAMP		
SIZE A	DWG. NO. SALES-PG-#C-#	REV A
SCALE: 1:16	WEIGHT:	SHEET 1 OF 1